

Aluminum Capacitors Power High Ripple Current Screw Terminals

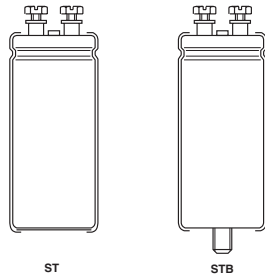

Fig.1 Component outline

FEATURES

- Polarized aluminum electrolytic capacitors, non-solid electrolyte
- Large types, cylindrical aluminum case, insulated with a blue sleeve
- Pressure relief in the sealing
- Long useful life



RoHS
COMPLIANT

APPLICATIONS

- Computer, telecommunications and industrial systems
- Smoothing and filtering
- Standard and switched mode power supplies

MARKING

The capacitors are marked with the following information:

- Rated capacitance (in μF)
- Tolerance on rated capacitance, code letter in accordance with IEC 60062 (M for $\pm 20\%$)
- Rated voltage (in V)
- Date code (YYMM)
- Name of manufacturer
- Code for factory of origin
- '-' sign to identify the negative terminal, visible from the top and side of the capacitor
- Code number
- Climatic category in accordance with IEC 60068

QUICK REFERENCE DATA		
DESCRIPTION	VALUE	
	101	102
Nominal case size ($\varnothing D \times L$ in mm)	35 x 60 to 76 x 146	
Rated capacitance range (E6 series), C_R	220 to 330000 μF	
Tolerance on C_R	$\pm 20\%$	
Rated voltage range, U_R	25 to 100 V	200 to 450 V
Category temperature range	- 40 to + 85 °C	
Endurance test at 85 °C	2000 hours	
Useful life at 85 °C	10000 hours ($D \leq 50$ mm) 15000 hours ($D \geq 65$ mm)	10000 hours
Useful life at 40 °C, 1.4 x I_R applied	400000 hours ($D \leq 50$ mm) 600000 hours ($D \geq 65$ mm)	400000 hours
Shelf life at 0 V, 85 °C	500 hours	
Based on sectional specification	IEC 60 384-4/EN130300	
Climatic category IEC 60068	40/085/56	

SELECTION CHART FOR C_R , U_R AND RELEVANT NOMINAL CASE SIZES ($\varnothing D \times L$ in mm)										
C_R (μF)	U_R (V)									
	25	40	63	100	200	250	350	385	400	450
220	-	-	-	-	-	-	-	35 x 60	35 x 60	35 x 60
330	-	-	-	-	-	-	35 x 60	-	35 x 60	-
470	-	-	-	-	-	35 x 60	-	35 x 80	35 x 80	-
	-	-	-	-	-	-	35 x 80	-	35 x 105	35 x 105
680	-	-	-	-	35 x 60	35 x 80	-	35 x 105	35 x 105	-
	-	-	-	-	-	-	35 x 105	-	50 x 80	50 x 80
1000	-	-	-	-	35 x 80	35 x 80	-	50 x 80	50 x 80	50 x 80
	-	-	-	-	35 x 105	35 x 105	50 x 80	-	50 x 105	50 x 105
1500	-	-	-	-	35 x 105	35 x 105	-	-	-	50 x 105
	-	-	-	-	50 x 80	50 x 80	50 x 105	50 x 105	50 x 105	65 x 105
2200	-	-	-	35 x 60	50 x 80	50 x 80	50 x 105	-	-	65 x 105
	-	-	-	-	-	50 x 105	65 x 105	65 x 105	65 x 105	-
3300	-	-	-	35 x 60	50 x 80	50 x 105	-	-	65 x 105	76 x 105
	-	-	-	35 x 80	50 x 105	65 x 105	65 x 105	76 x 105	-	76 x 146
4700	-	-	35 x 60	35 x 80	-	65 x 105	76 x 105	76 x 105	76 x 105	76 x 146
	-	-	-	35 x 105	65 x 105	76 x 105	76 x 146	76 x 146	76 x 146	-
5600	-	-	-	-	-	-	-	-	-	76 x 146

SELECTION CHART FOR C_R, U_R AND RELEVANT NOMINAL CASE SIZES (∅ D × L in mm)										
C _R (μF)	U _R (V)									
	25	40	63	100	200	250	350	385	400	450
6800	-	-	35 x 60	35 x 105	65 x 105	76 x 105	-	-	-	-
	-	-	35 x 80	50 x 80	76 x 105	76 x 146	76 x 146	76 x 146	76 x 146	-
10000	-	35 x 60	35 x 80	50 x 80	76 x 105	76 x 105	-	-	-	-
	-	-	35 x 105	50 x 105	76 x 146	76 x 146	-	-	-	-
15000	35 x 60	35 x 60	35 x 105	50 x 105	76 x 146	-	-	-	-	-
	-	35 x 80	50 x 80	-	-	-	-	-	-	-
22000	35 x 60	35 x 80	50 x 80	65 x 105	-	-	-	-	-	-
	-	50 x 80	50 x 105	76 x 105	-	-	-	-	-	-
33000	35 x 80	35 x 105	50 x 105	76 x 105	-	-	-	-	-	-
	50 x 80	50 x 80	65 x 105	76 x 146	-	-	-	-	-	-
47000	35 x 105	50 x 80	65 x 105	-	-	-	-	-	-	-
	50 x 80	50 x 105	76 x 105	76 x 146	-	-	-	-	-	-
68000	50 x 80	50 x 105	65 x 105	-	-	-	-	-	-	-
	50 x 105	65 x 105	76 x 146	-	-	-	-	-	-	-
100000	50 x 105	65 x 105	-	-	-	-	-	-	-	-
	65 x 105	76 x 105	76 x 146	-	-	-	-	-	-	-
150000	65 x 105	76 x 105	-	-	-	-	-	-	-	-
	76 x 105	76 x 146	-	-	-	-	-	-	-	-
220000	65 x 105	-	-	-	-	-	-	-	-	-
	76 x 105	76 x 146	-	-	-	-	-	-	-	-
330000	76 x 146	-	-	-	-	-	-	-	-	-

DIMENSIONS in millimeters AND AVAILABLE FORMS

Fig.2 Screw terminal (ST); screw terminal bolt (STB)

Maximum permissible torque which may be applied to the termination screws: 2 Nm.
 For accessories refer to datasheet "Mounting Accessories".
 The capacitors are delivered with screws and washers.

Table 1

DIMENSIONS in millimeters, MASS AND PACKAGING QUANTITIES										
NOMINAL CASE SIZE ∅ D × L	∅ D _{max}	L _{max}	P ± 0.3	A ± 0.5	d ₁ ± 0.2	T ± 0.5	d ₂ × l	MASS (g)	PACKAGING QUANTITIES (per box)	CARDBOARD BOX DIMENSIONS L × W × H
35 × 60	36	63	13	8	8	5.9	M8 × 12	75	25	196 × 192 × 110
35 × 80	36	81	13	8	8	5.9	M8 × 12	95	25	196 × 192 × 115
35 × 105	36	105	13	8	8	5.9	M8 × 12	130	25	196 × 192 × 140
50 × 80	51.5	83	22	12	8	5.9	M12 × 16	200	25	293 × 273 × 115
50 × 105	51.5	105	22	12	8	5.9	M12 × 16	300	25	293 × 273 × 140
65 × 105	66	105	28.5	16	8*	5.9*	M12 × 16	480	10	368 × 151 × 140
76 × 105	77	106	32	19	8*	5.9*	M12 × 16	700	10	418 × 173 × 140
76 × 146	77	146	32	19	8*	5.9*	M12 × 16	1000	10	418 × 173 × 180

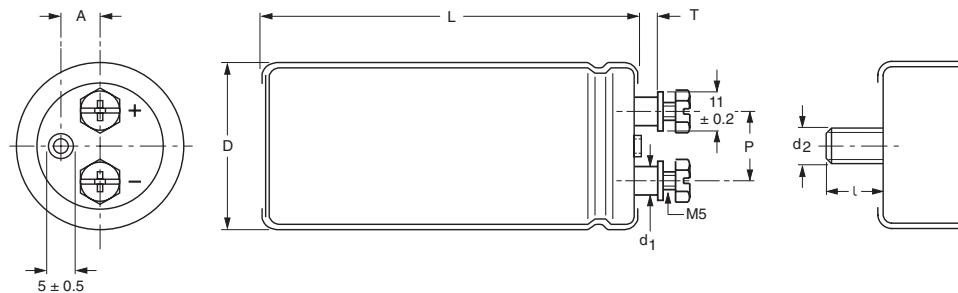
* Terminals also available in High Current version. Contact manufacturer for mechanical dimensions.

ELECTRICAL DATA	
SYMBOL	DESCRIPTION
C_R	rated capacitance at 100 Hz, tolerance $\pm 20\%$
I_R	rated RMS ripple current at 100 Hz, 85 °C
I_{L5}	max. leakage current after 5 minutes at U_R
ESR	max. equivalent series resistance at 100 Hz
Z	max. impedance at 20 kHz

ORDERING EXAMPLE

Electrolytic capacitor 101 series

10000 $\mu\text{F}/40\text{ V}$; $\pm 20\%$

Nominal case size: $\varnothing 35 \times 60\text{ mm}$;
ST version, high post M5 disc

Catalog number: 2222 101 17103.

Note

- Unless otherwise specified, all electrical values in Tables 2 and 3 apply at $T_{\text{amb}} = 20\text{ °C}$, $P = 86\text{ to }106\text{ kPa}$, $\text{RH} = 45\text{ to }75\%$.

Table 2

ELECTRICAL DATA AND ORDERING INFORMATION FOR 101 SERIES								
U_R (V)	C_R 100 Hz (μF)	NOMINAL CASE SIZE $\varnothing D \times L$ (mm)	I_R 100 Hz 85 °C (A)	I_{L5} 5 min (mA)	ESR max 100 Hz (m Ω)	Z MAX. 20 kHz (m Ω)	HIGH POST M5 DISC	
							CATALOG NUMBER ST 2222 101	CATALOG NUMBER STB 2222 101
25	15000	35 x 60	7.7	0.75	29	22	16153	56153
	22000	35 x 60	8.3	1.10	27	22	16223	56223
	33000	35 x 80	9.0	1.65	19	17	16333	56333
	33000	50 x 80	10.0	1.65	17	14	26333	66333
	47000	35 x 105	12.1	2.35	15	13	16473	56473
	47000	50 x 80	14.8	2.35	12	10	26473	66473
	68000	50 x 80	12.8	3.40	15	13	16683	56683
	68000	50 x 105	17.1	3.40	9	8	26683	66683
	100000	50 x 105	14.7	5.00	12	11	16104	56104
	100000	65 x 105	19.6	5.00	7	6	26104	66104
	150000	65 x 105	17.6	7.50	8	7	16154	56154
	150000	76 x 105	21.4	7.50	6	5	26154	66154
	220000	65 x 105	20.2	11.00	6	5	16224	56224
	220000	76 x 105	22.5	11.00	6	5	26224	66224
	330000	76 x 146	25.8	16.50	4	4	26334	66334
40	10000	35 x 60	7.1	0.80	31	23	17103	57103
	15000	35 x 60	7.8	1.20	28	22	17153	57153
	15000	35 x 80	8.7	1.20	22	17	27153	67153
	22000	35 x 80	9.4	1.76	20	17	17223	57223
	22000	50 x 80	11.2	1.76	19	15	27223	67223
	33000	35 x 105	11.0	2.64	15	13	17333	57333
	33000	50 x 80	13.7	2.64	13	10	27333	67333
	47000	50 x 80	14.6	3.76	12	10	17473	57473
	47000	50 x 105	15.9	3.76	10	8	27473	67473
	68000	50 x 105	16.9	5.44	9	8	17683	57683
	68000	65 x 105	18.1	5.44	7	6	27683	67683
	100000	65 x 105	19.2	8.00	7	6	17104	57104
	100000	76 x 105	21.3	8.00	7	6	27104	67104
	150000	76 x 105	20.5	12.00	7	6	17154	57154
	150000	76 x 146	24.0	12.00	5	5	27154	67154
	220000	76 x 146	24.5	17.60	5	5	27224	67224



Aluminum Capacitors
Power High Ripple Current Screw Terminals

Vishay BCcomponents

ELECTRICAL DATA AND ORDERING INFORMATION FOR 101 SERIES								
U _R (V)	C _R 100 Hz (μF)	NOMINAL CASE SIZE ∅ D × L (mm)	I _R 100 Hz 85 °C (A)	I _{L5} 5 min (mA)	ESR max 100 Hz (mΩ)	Z MAX. 20 kHz (mΩ)	HIGH POST M5 DISC	
							CATALOG NUMBER ST 2222 101	CATALOG NUMBER STB 2222 101
63	4700	35 x 60	5.9	0.59	42	25	18472	58472
	6800	35 x 60	6.6	0.86	38	25	18682	58682
	6800	35 x 80	7.3	0.86	30	19	28682	68682
	10000	35 x 80	8.1	1.26	27	19	18103	58103
	10000	35 x 105	8.8	1.26	22	14	28103	68103
	15000	35 x 105	9.7	1.89	19	14	18153	58153
	15000	50 x 80	12.1	1.89	16	11	28153	68153
	22000	50 x 80	11.1	2.77	19	15	18223	58223
	22000	50 x 105	14.3	2.77	12	9	28223	68223
	33000	50 x 105	12.9	4.16	14	12	18333	58333
	33000	65 x 105	16.5	4.16	9	6	28333	68333
	47000	65 x 105	15.6	5.92	10	8	18473	58473
	47000	76 x 105	18.6	5.92	8	6	28473	68473
	68000	76 x 105	20.0	8.57	7	6	18683	58683
	68000	76 x 146	21.9	8.57	6	5	28683	68683
	100000	76 x 146	23.4	12.60	5	5	28104	68104
100	2200	35 x 60	5.2	0.44	50	29	19222	59222
	3300	35 x 60	6.0	0.66	42	27	19332	59332
	3300	35 x 80	6.6	0.66	35	21	29332	69332
	4700	35 x 80	7.3	0.94	31	20	19472	59472
	4700	35 x 105	7.9	0.94	26	16	29472	69472
	6800	35 x 105	8.8	1.36	23	15	19682	59682
	6800	50 x 80	10.9	1.36	19	12	29682	69682
	10000	50 x 80	10.5	2.00	21	15	19103	59103
	10000	50 x 105	13.1	2.00	14	9	29103	69103
	15000	50 x 105	12.3	3.00	16	12	19153	59153
	22000	65 x 105	14.8	4.40	11	8	19223	59223
	22000	76 x 105	17.4	4.40	9	6	29223	69223
	33000	76 x 105	19.0	6.60	8	6	19333	59333
	33000	76 x 146	20.7	6.60	7	5	29333	69333
	47000	76 x 146	22.4	9.40	6	5	29473	69473

Table 3

ELECTRICAL DATA AND ORDERING INFORMATION FOR 102 SERIES								
U _R (V)	C _R 100 Hz (μF)	NOMINAL CASE SIZE ∅ D × L (mm)	I _R 100 Hz 85 °C (A)	I _{L5} 5 min (mA)	ESR max 100 Hz (mΩ)	Z MAX. 20 kHz (mΩ)	HIGH POST M5 DISC	
							CATALOG NUMBER ST 2222 102	CATALOG NUMBER STB 2222 102
200	680	35 x 60	3.5	0.27	207	136	12681	52681
	1000	35 x 80	4.4	0.40	144	95	12102	52102
	1000	35 x 105	4.7	0.40	140	91	22102	62102
	1500	35 x 105	5.5	0.60	100	67	12152	52152
	1500	50 x 80	6.2	0.60	106	74	22152	62152
	2200	50 x 80	8.0	0.88	67	44	12222	52222
	3300	50 x 80	8.9	1.32	50	35	12332	52332
	3300	50 x 105	9.9	1.32	46	32	22332	62332
	4700	65 x 105	12.5	1.88	37	26	22472	62472
	6800	65 x 105	15.2	2.72	25	18	12682	52682
	6800	76 x 105	16.9	2.72	25	18	22682	62682
	10000	76 x 105	19.9	4.00	18	13	12103	52103
	10000	76 x 146	20.4	4.00	18	13	22103	62103
	15000	76 x 146	24.1	6.00	12	9	12153	52153
250	470	35 x 60	3.1	0.24	250	152	13471	53471
	680	35 x 80	3.8	0.34	175	107	13681	53681
	1000	35 x 80	4.4	0.50	128	82	13102	53102
	1000	35 x 105	4.8	0.50	122	76	23102	63102
	1500	35 x 105	5.4	0.75	90	58	13152	53152
	1500	50 x 80	7.0	0.75	81	50	23152	63152
	2200	50 x 80	8.0	1.10	60	39	13222	53222
	2200	50 x 105	8.7	1.10	57	35	23222	63222
	3300	50 x 105	9.8	1.65	42	28	13332	53332
	3300	65 x 105	11.4	1.65	42	28	23332	63332
	4700	65 x 105	13.8	2.35	29	19	13472	53472
	4700	76 x 105	15.3	2.35	29	19	23472	63472
	6800	76 x 105	18.1	3.40	21	14	13682	53682
	6800	76 x 146	18.6	3.40	21	14	23682	63682
	10000	76 x 105	19.3	5.00	17	12	13103	53103
	10000	76 x 146	22.0	5.00	15	10	23103	63103
350	330	35 x 60	2.5	0.23	435	305	15331	55331
	470	35 x 80	3.1	0.33	308	216	25471	65471
	680	35 x 105	3.8	0.48	216	152	25681	65681
	1000	50 x 80	5.6	0.70	145	102	25102	65102
	1500	50 x 80	6.5	1.05	102	74	15152	55152
	1500	50 x 105	7.0	1.05	99	70	25152	65152
	2200	50 x 105	8.0	1.54	72	52	15222	55222
	2200	65 x 105	9.3	1.54	72	52	25222	65222
	3300	65 x 105	11.4	2.31	48	35	25332	65332
	4700	76 x 105	15.0	3.29	34	25	15472	55472
	4700	76 x 146	15.4	3.29	34	25	25472	65472
	6800	76 x 146	18.3	4.76	24	18	25682	65682



Aluminum Capacitors
Power High Ripple Current Screw Terminals

Vishay BCcomponents

ELECTRICAL DATA AND ORDERING INFORMATION FOR 102 SERIES								
U _R (V)	C _R 100 Hz (µF)	NOMINAL CASE SIZE ∅ D × L (mm)	I _R 100 Hz 85 °C (A)	I _{L5} 5 min (mA)	ESR max 100 Hz (mΩ)	Z MAX. 20 kHz (mΩ)	HIGH POST M5 DISC	
							CATALOG NUMBER ST 2222 102	CATALOG NUMBER STB 2222 102
385	220	35 x 60	2.1	0.17	575	380	18221	58221
	330	35 x 80	2.7	0.26	386	257	18331	58331
	470	35 x 80	3.1	0.37	279	188	18471	58471
	680	35 x 105	3.9	0.53	196	133	18681	58681
	1000	50 x 80	5.6	0.77	132	89	18102	58102
	1500	50 x 105	7.1	1.16	90	61	18152	58152
	2200	65 x 105	10.0	1.70	61	42	18222	58222
	3300	76 x 105	13.4	2.55	42	29	18332	58332
	4700	76 x 105	15.0	3.62	31	22	18472	58472
	4700	76 x 146	16.3	3.62	29	20	28472	68472
	6800	76 x 146	18.3	5.24	22	16	18682	58682
400	220	35 x 60	2.1	0.18	557	363	16221	56221
	330	35 x 60	2.5	0.26	383	254	16331	56331
	330	35 x 80	2.7	0.26	374	245	26331	66331
	470	35 x 80	3.1	0.38	271	180	16471	56471
	470	35 x 105	3.3	0.38	265	175	26471	66471
	680	35 x 105	3.9	0.55	191	128	16681	56681
	680	50 x 80	4.5	0.54	199	136	26681	66681
	1000	50 x 80	5.7	0.80	128	86	16102	56102
	1000	50 x 105	6.0	0.80	125	83	26102	66102
	1500	50 x 105	7.1	1.20	88	59	26152	66152
	2200	65 x 105	10.0	1.76	60	40	26222	66222
	3300	65 x 105	12.1	2.64	40	27	16332	56332
	3300	76 x 105	13.4	2.64	40	27	26332	66332
	4700	76 x 105	15.0	3.76	31	21	16472	56472
	4700	76 x 146	16.4	3.76	28	19	26472	66472
	6800	76 x 146	18.3	5.44	22	15	26682	66682
	450	220	35 x 60	2.1	0.20	503	313	17221
330		35 x 80	2.7	0.30	339	212	27331	67331
470		35 x 105	3.4	0.42	241	151	27471	67471
680		50 x 80	4.9	0.61	159	98	27681	67681
1000		50 x 80	5.7	0.90	118	75	17102	57102
1000		50 x 105	6.1	0.90	114	72	27102	67102
1500		50 x 105	7.1	1.35	81	52	17152	57152
1500		65 x 105	8.3	1.35	81	52	27152	67152
2200		65 x 105	10.1	1.98	55	35	17222	57222
2200		76 x 105	11.2	1.98	55	35	27222	67222
3300		76 x 105	13.5	2.97	37	24	17332	57332
3300		76 x 146	13.9	2.97	37	24	27332	67332
4700		76 x 146	16.4	4.23	26	17	17472	57472
5600		76 x 146	17.3	5.04	23	15	17562	57562



ADDITIONAL ELECTRICAL DATA		
PARAMETER	CONDITIONS	VALUE
Voltage		
Surge voltage	≤ 250 V versions	$U_s = 1.15 \times U_R$
	≥ 350 V versions	$U_s = 1.1 \times U_R$
Reverse voltage		$U_{rev} \leq 1 \text{ V}$
Current		
Leakage current in μA	after 1 minute at U_R	$I_{L1} \leq 0.006 C_R \times U_R$
	after 5 minutes at U_R	$I_{L5} \leq 0.002 C_R \times U_R$
Inductance		
Equivalent series inductance (ESL)	case $\varnothing D = 35 \text{ mm}$	typ. 13 nH
	case $\varnothing D = 50 \text{ mm}$	typ. 16 nH
	case $\varnothing D = 65 \text{ mm}$	typ. 19 nH
	case $\varnothing D = 76 \text{ mm}$	typ. 20 nH

RIPPLE CURRENT AND USEFUL LIFE

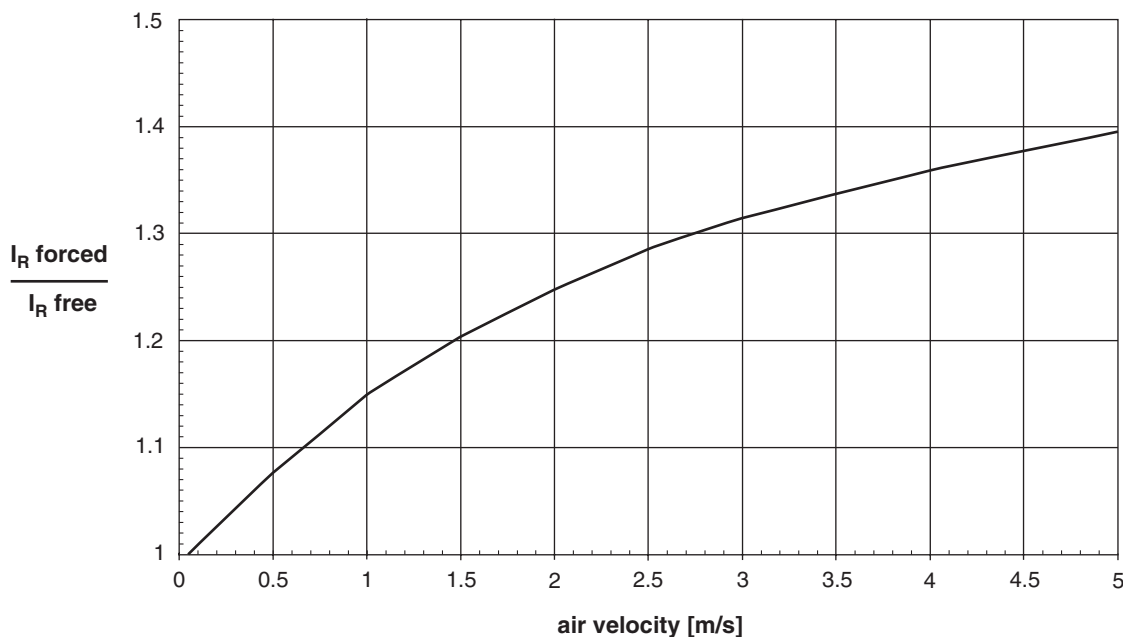

Fig.3 Multiplier of ripple current (I_r) as a function of air flow

MAXIMUM RIPPLE CURRENT			
PARAMETER	CONDITION	MAXIMUM RIPPLE CURRENT MULTIPLIER	VALUE
Ambient temperature (T_{amb})	70 °C	from nomogram; see fig. 4	1.6
Operating frequency (f)	400 Hz	from frequency ; table 4	1.3
Air flow	2 m/s	from air-flow; see fig. 3	1.25

Note

Calculation example for 102 series. Maximum ripple current multiplier = 1.6 x 1.3 x 1.25 = 2.6



Aluminum Capacitors
Power High Ripple Current Screw Terminals

Vishay BCcomponents

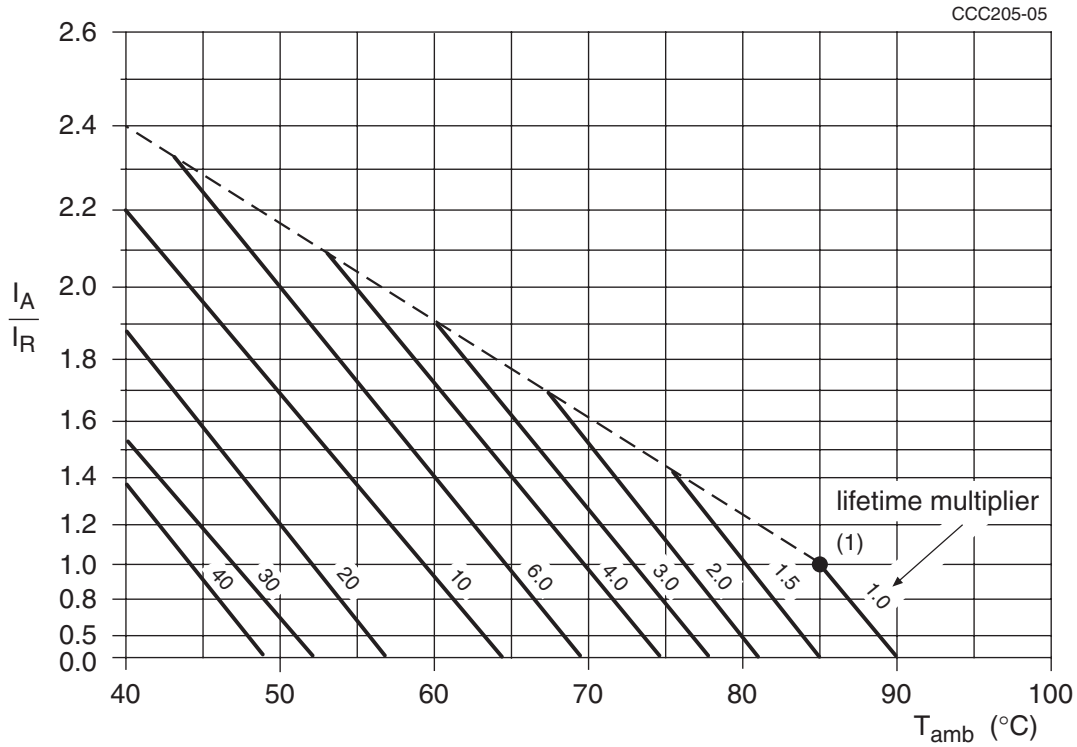

I_A = actual ripple current at 100 Hz
 I_R = rated ripple current at 100 Hz and 85 °C

- (1) Useful life at 85 °C and I_R applied:
101 series: case $\varnothing D \leq 50$: 10000 hours
case $\varnothing D \geq 65$: 15000 hours
102 series: 10000 hours

Fig.4 Multiplier of useful life as a function of ambient temperature and ripple current load

Table 4

MULTIPLIER OF RIPPLE CURRENT (I_R) AS A FUNCTION OF FREQUENCY		
FREQUENCY (Hz)	I_R MULTIPLIER	
	101	102
50	0.85	0.90
100	1.00	1.00
200	1.10	1.20
400	1.15	1.30
1000	1.20	1.40
10000	1.30	1.50

Table 5

TEST PROCEDURES AND REQUIREMENTS			
TEST		PROCEDURE (quick reference)	REQUIREMENTS
NAME OF TEST	REFERENCE		
Endurance	IEC 60384-4/ EN130300 subclause 4.13	$T_{amb} = 85\text{ }^{\circ}\text{C}$; U_R applied; 2000 hours	$U_R \leq 100\text{ V}$; $\Delta C/C: \pm 15\%$ $U_R > 100\text{ V}$; $\Delta C/C: \pm 10\%$ $\tan \delta \leq 1.3 \times \text{spec. limit}$ $Z \leq 2 \times \text{spec. limit}$ $I_{L5} \leq \text{spec. limit}$
Useful life	CECC 30301 subclause 1.8.1	$T_{amb} = 85\text{ }^{\circ}\text{C}$; U_R and I_R applied; 101 series: case $\varnothing D \leq 50$:10000 hours case $\varnothing D \geq 65$:15000 hours 102 series: 10000 hours	$U_R \leq 100\text{ V}$; $\Delta C/C: \pm 45\%$ $U_R > 100\text{ V}$; $\Delta C/C: \pm 30\%$ $\tan \delta \leq 3 \times \text{spec. limit}$ $Z \leq 3 \times \text{spec. limit}$ $I_{L5} \leq \text{spec. limit}$ no short or open circuit, no visible damage total failure percentage: $U_R \leq 100\text{ V}: \leq 1\%$; $U_R > 100\text{ V}: \leq 3\%$
Shelf life (storage at high temperature)	IEC 60384-4/ EN130300 subclause 4.17	$T_{amb} = 85\text{ }^{\circ}\text{C}$; no voltage applied; 500 hours after test: U_R to be applied for 30 minutes, 24 to 48 hours before measurement	$\Delta C/C: \pm 10\%$ $\tan \delta \leq 1.2 \times \text{spec. limit}$ $I_{L5} \leq 2 \times \text{spec. limit}$



Notice

Specifications of the products displayed herein are subject to change without notice. Vishay Intertechnology, Inc., or anyone on its behalf, assumes no responsibility or liability for any errors or inaccuracies.

Information contained herein is intended to provide a product description only. No license, express or implied, by estoppel or otherwise, to any intellectual property rights is granted by this document. Except as provided in Vishay's terms and conditions of sale for such products, Vishay assumes no liability whatsoever, and disclaims any express or implied warranty, relating to sale and/or use of Vishay products including liability or warranties relating to fitness for a particular purpose, merchantability, or infringement of any patent, copyright, or other intellectual property right.

The products shown herein are not designed for use in medical, life-saving, or life-sustaining applications. Customers using or selling these products for use in such applications do so at their own risk and agree to fully indemnify Vishay for any damages resulting from such improper use or sale.